

TIMING BELT COMPONENTS FOR REMOVAL AND INSTALLATION

EQ6YV-01

EG

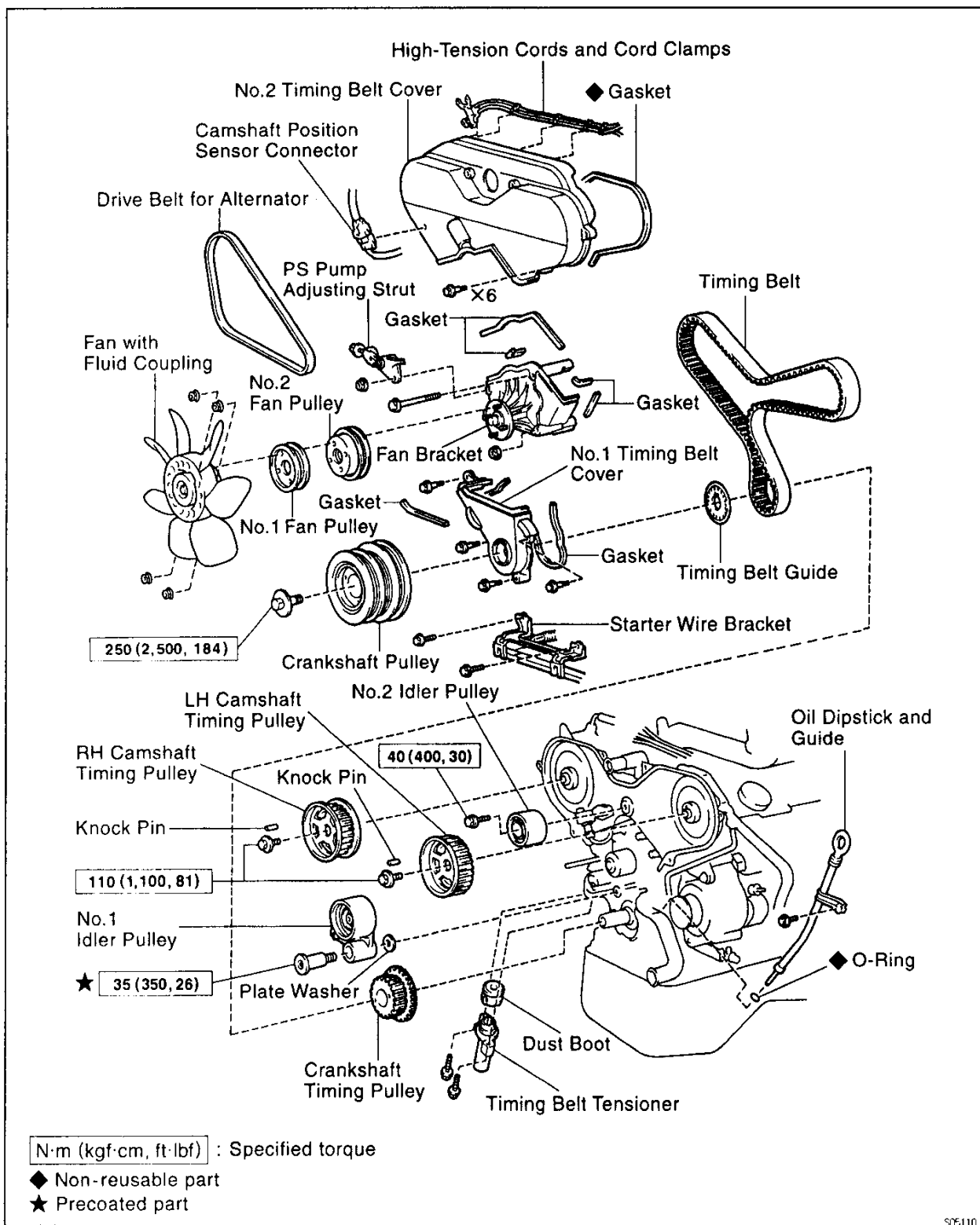

S05110

TIMING BELT REMOVAL

1. LOOSEN FAN WITH FLUID COUPLING AND FAN PULLEYS
2. REMOVE DRIVE BELT FOR ALTERNATOR
3. REMOVE FAN WITH FLUID COUPLING AND FAN PULLEYS
4. REMOVE OIL DIPSTICK AND GUIDE

Remove the bolt, oil dipstick, guide and O-ring.

5. REMOVE NO.2 TIMING BELT COVER

- (a) Disconnect the 4 high-tension cord clamps from the No.2 timing belt cover.
- (b) Remove the 6 bolts and No.2 timing belt cover.
- (c) Disconnect the camshaft position sensor connector.

EG

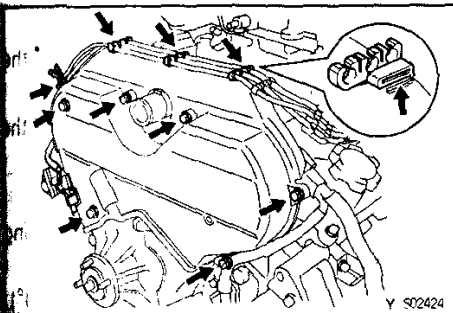
**6. REMOVE FAN BRACKET**

- (a) Remove the nut and PS pump adjusting strut.
- (b) Remove the bolt, nut, and fan bracket.

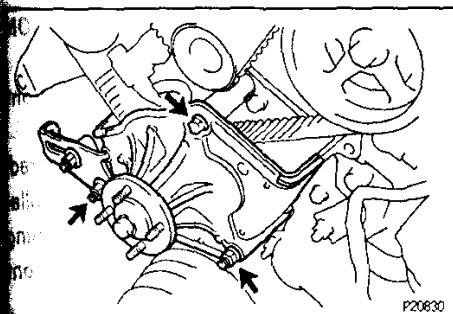
**7. REMOVE CRANKSHAFT PULLEY**

- (a) Using SST, loosen the pulley bolt.
SST 09213-54015 (90119-08216),
09330-00021
- (b) Remove the SST, pulley bolt and pulley.

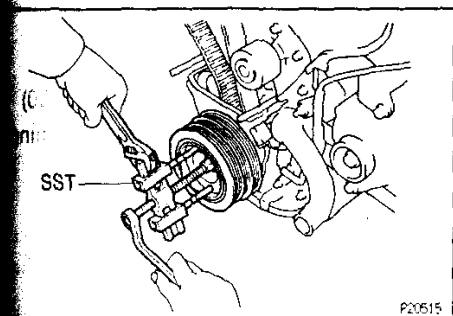
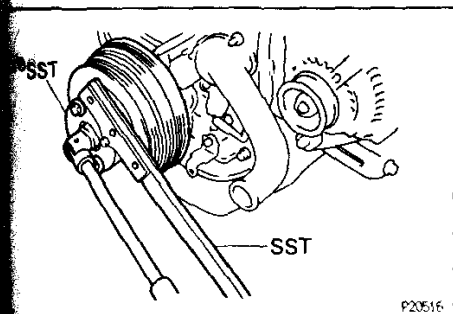

HINT: If necessary, remove the pulley with SST and service bolt.

SST 09950-50010 (09551-05010, 09552-05010,
09553-05020, 09554-05030)